

INSTRUCTION SHEET

The Legend

MARQUE : CFMOTO

MODEL : CFORCE 600

#272

CYLINDER: 600 CC

YEARS : 2010-2013

APPLICATION :



Top view

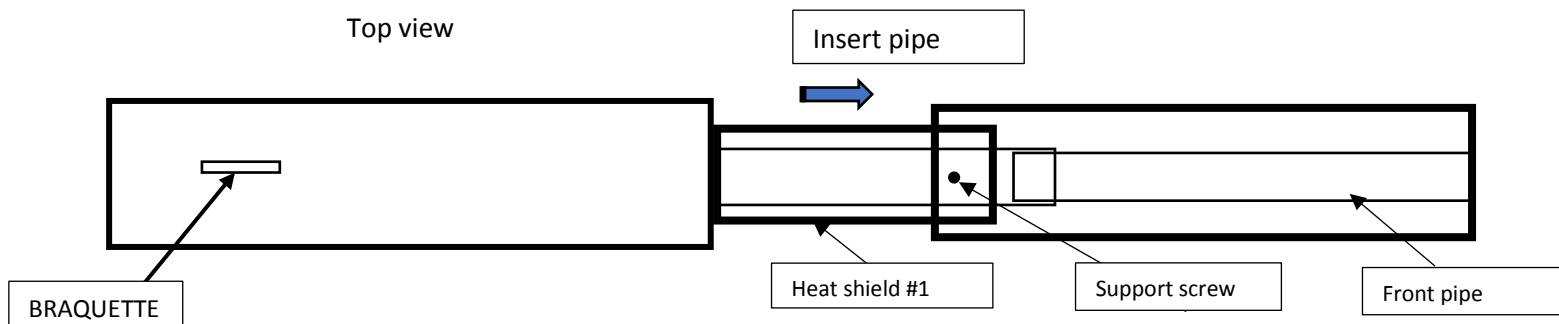

1. To fix the bracket on the ATV

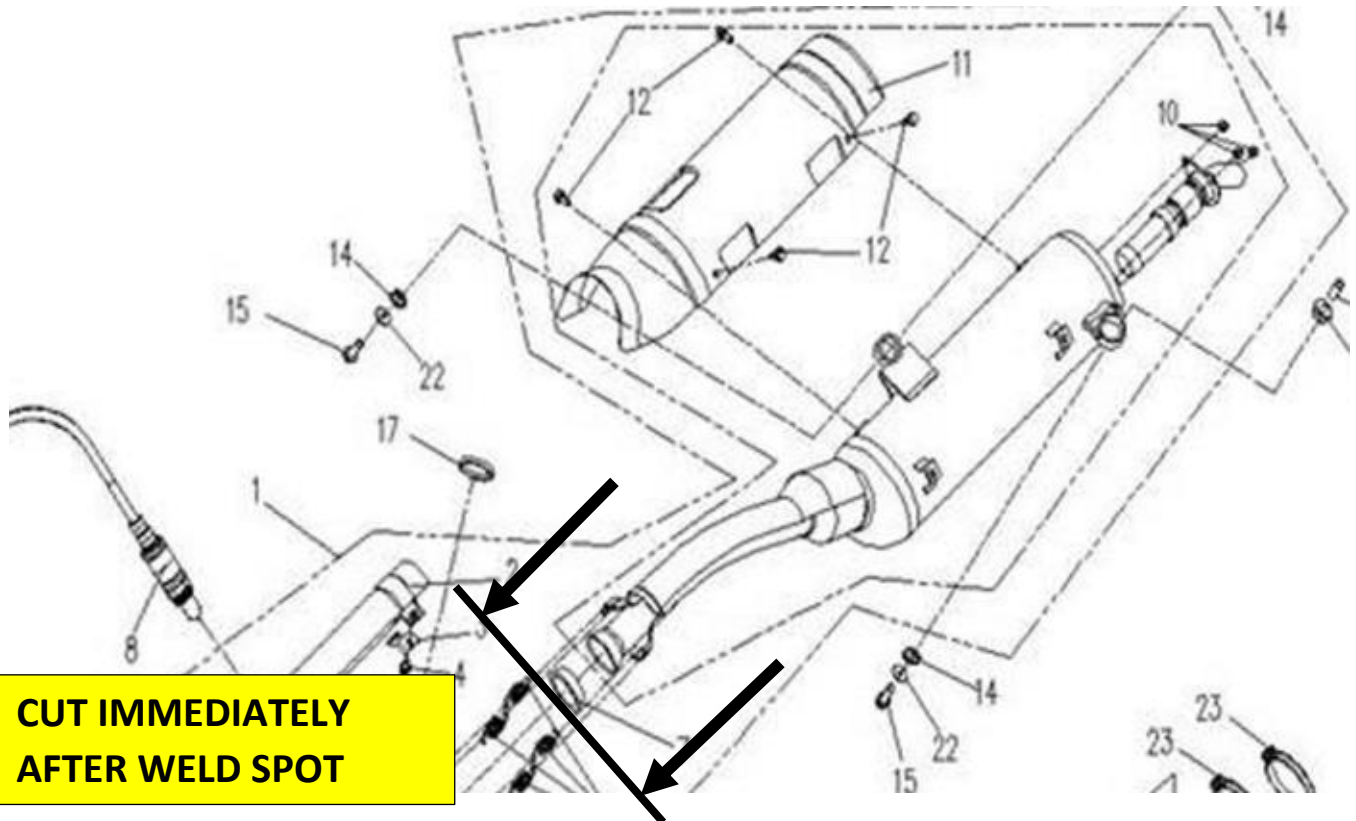

2. There is only one screw for all heat shield.
3. screw the retaining vis on the heat shield #2 . Let see picture below the heat shield #2 fit on the second heat shield.

The heat shield #2 is very important



PARE CHALEUR #1